

5d Stonebrack Piece

Abbeymead Gloucester Gloucestershire GL4 5TE

readmaurice 



A nicely presented first floor two bedroom flat located in the ever popular Abbeymead area with allocated parking and gas fired central heating. It is available for a minimum period of 12 months.

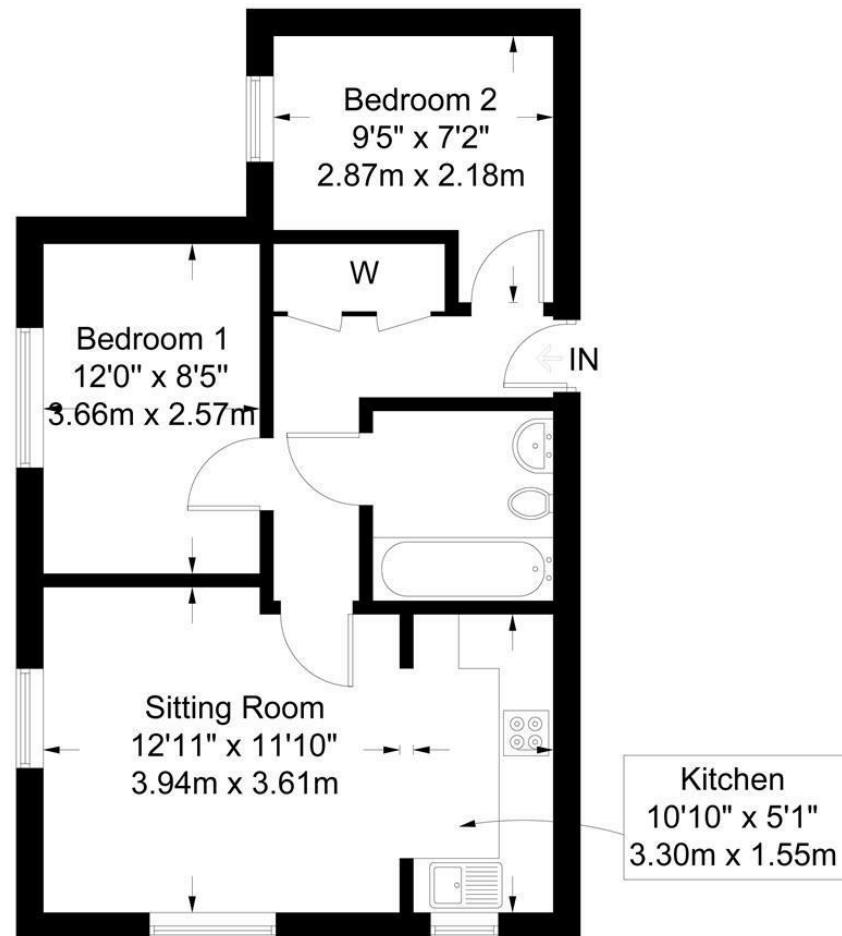

Approximate Gross Internal Area = 528 sq ft / 49.1 sq m

Illustration for identification purposes only, measurements are approximate and are not to scale.
Please check all details before making any decisions reliant upon them.
Copyright Read Maurice. (ID296418)

The accommodation offers fitted kitchen that opens onto the living space, two bedrooms and white bathroom suite with shower over bath. The property comes with one allocated parking space with additional visitors spaces and use of the communal gardens.

There is a secure entry phone system and bike store. Sorry no sharers. No pets.

ACCOMMODATION:

Two bedrooms
Sitting room
Kitchen
Bathroom

ADDITIONAL:

Gas fired central heating
Unfurnished

INCLUDED:

Oven & hob
Washing machine
Fridge freezer

TERM:

12 minimum term.

The accommodation offers fitted kitchen that opens onto the living space, two bedrooms and white bathroom suite with shower over bath. The property comes with one allocated parking space with additional visitors spaces and use of the communal gardens. There is a secure entry phone system and bike store. Sorry no sharers. No pets.

ACCOMMODATION:

Two bedrooms
Sitting room
Kitchen
Bathroom

ADDITIONAL:

Gas fired central heating
Unfurnished

General

Local Authority: Gloucester City Council

Council Tax: B

EPC: 80

readmaurice 

48 Andover Road, Cheltenham, GL50 2TL

Tel: 01242 241122

Email: post@readmaurice.co.uk

www.readmaurice.co.uk

5d Stonebrack Piece Abbeymead Gloucester Gloucestershire GL4 5TE

These particulars, whilst believed to be accurate are set out as a general outline only for guidance and do not constitute any part of an offer or contract. Intending purchasers should not rely on them as statements or representation of fact, but must satisfy themselves by inspection or otherwise as to their accuracy. We have not carried out a detailed survey nor tested the services, appliances and specific fittings. Room sizes should not be relied upon for carpets and furnishings. The measurements given are approximate. No person in this firm's employment has the authority to make or give any representation or warranty in respect of the property. Purchasers should not rely on room labels they are chosen by the floor planner and may not have the deemed planning consent for such use.