

19 Brook House

Belworth Drive Cheltenham GL51 6EZ

readmaurice 



A SPACIOUS TWO BEDROOM PENTHOUSE APARTMENT WITH A PRIVATE BALCONY WITH GLORIOUS VIEWS LOCATED BETWIXT HATHERLEY AND MONTPELLIER.

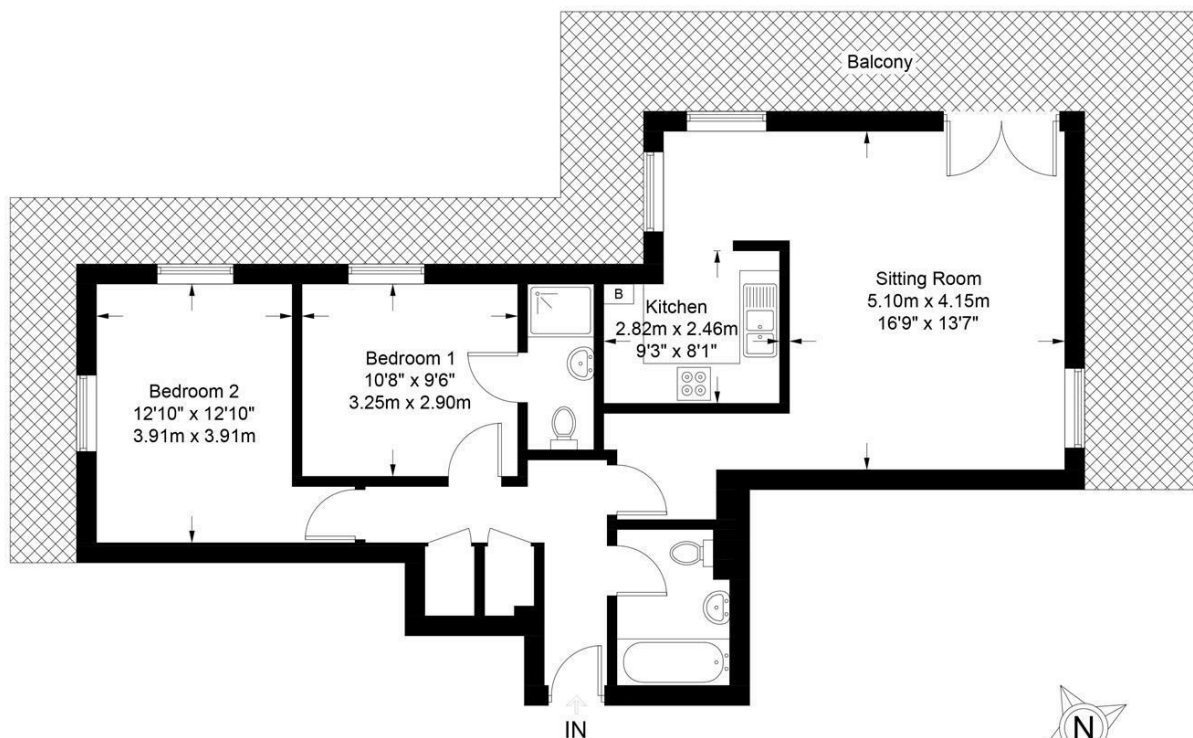

Approximate Gross Internal Area = 789 sq ft / 73.3 sq m

Illustration for identification purposes only, measurements are approximate and are not to scale.

Please check all details before making any decisions reliant upon them.

Copyright Read Maurice. (ID1026685)

ACCOMMODATION:

2 bedroom top floor apartment with exceptional views over Cheltenham with a 270° balcony. Large open plan sitting room and the benefit of both a bathroom and an En suite shower room. Available for immediate occupation on an unfurnished basis.

PARKING:

2 gated off road parking spaces.

ADDITIONAL:

Gas fired central Heating
Double glazed windows.
Unfurnished

INCLUDED:

Integrated appliances include oven and hob, microwave.
Free standing fridge freezer

TERM

12 months minimum term. No pets. No smokers.

VIEWING AND SHOWING TIMES:

Read Maurice show our rental property during weekdays only. No application may be made without a physical viewing of the property. For certain properties block viewings will be offered and you are advised to attend at the earliest opportunity if this property is of interest to you.

GENERAL:

Mains services are believed to be connected

General

Local Authority: Cheltenham

Council Tax: B

EPC: Band C

Rating: 79

Title Number: GR265846

readmaurice 

48 Andover Road, Cheltenham, GL50 2TL

Tel: 01242 241122

Email: post@readmaurice.co.uk

www.readmaurice.co.uk

19 Brook House Belworth Drive Cheltenham GL51 6EZ

These particulars, whilst believed to be accurate are set out as a general outline only for guidance and do not constitute any part of an offer or contract. Intending purchasers should not rely on them as statements or representation of fact, but must satisfy themselves by inspection or otherwise as to their accuracy. We have not carried out a detailed survey nor tested the services, appliances and specific fittings. Room sizes should not be relied upon for carpets and furnishings. The measurements given are approximate. No person in this firm's employment has the authority to make or give any representation or warranty in respect of the property. Purchasers should not rely on room labels they are chosen by the floor planner and may not have the deemed planning consent for such use.